

November 21, 2017

EASTBOUND LAKE SHORE BLVD W RAMP CLOSURE at Palace Pier Court

Road resurfacing of ramp from Palace Pier Court

Contract: 17ECS-TI-12SP

Closure Start Date: 7:00P.M. Friday, November 24, 2017

Closure End Date: 5:00AM Monday November 27, 2017

**Timeline is subject to change.*

The City contractor's work on Lake Shore Boulevard West continues. In order to safely restore this section of the street, **the eastbound Lake Shore Blvd ramp from Palace Pier Court easterly will be closed for road base repair and road resurfacing.**





Please see traffic management section below.

Weather permitting this work will take place from

7:00 PM Friday November 24 to 5:00 A.M. Monday, November 27, 2017.

Further updates regarding the remaining work will be delivered in the coming weeks.

WHAT TO EXPECT DURING CONSTRUCTION

	<p>This road work will take place 24/7.</p> <ul style="list-style-type: none"> The loudest portion of work is on the night of November 24th when breaking and removal of concrete and asphalt will take place. This type of work is expected to continue overnight. Regular work hours on this project will resume on November 27
	<p>Traffic Management:</p> <ul style="list-style-type: none"> Eastbound traffic on Lake Shore Blvd will not be accessible east of Palace Pier Court, due to the closures of the Palace Pier Court intersection and the closure of Lake Shore Blvd W access ramp closure. One curb lane in each direction on Lake Shore Blvd W will be maintained west of Palace Pier Court. Local traffic accessing from Lake Shore to Place Pier will be maintained Palace Pier residents should use Waterfront/Marine Parade to access Lake Shore Blvd W <p><i>Efforts have been made to manage traffic in the area for the safety of workers, road users and residents. Road users should expect delays and increased traffic on nearby main and side streets.</i></p>
	<p>TTC Service: 501/301 Queen buses on Lake Shore Blvd W will be maintained through the intersection /work zone, while other bus routes may need to be diverted around the work zone. TTC Route/Schedules/Fares: 416-393-4636 or visit ttc.ca.</p>
	<p>Pedestrian Access: No pedestrian crossing will be maintained at the intersection of Palace Pier Ct and Lake Shore Blvd West. Pedestrians must walk to Brookers Lane to cross Lake Shore Blvd West.</p>
	<p>Accommodation: Residents that require accommodation must contact the Project Information Line to arrange for access during construction.</p>



Businesses will be open throughout construction. All are welcome to dine and shop locally.

CLOSURE MAP

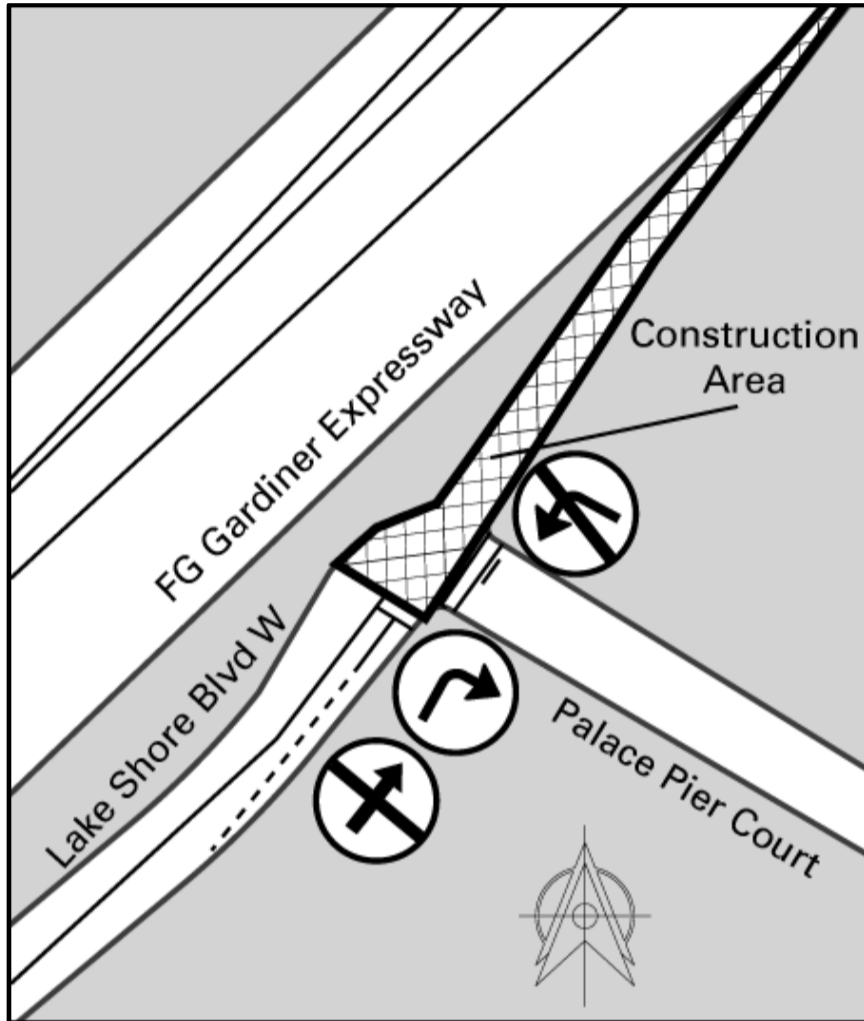

Parking: Parking in the active work zone is not permitted due to space requirements for construction equipment and materials. If your parked vehicle affects the construction work, it will be re-located with no charge to the owner. If your vehicle is moved, please contact parking control for its location at **416-808-2222**.

NEED MORE INFORMATION?

If you have questions about the upcoming work, please contact us.

Project Manager	Shahid Virk, 416-338-5542 shahid.virk@toronto.ca
TTY Hearing Impaired Service	416-338-0889 (7 Days a week, 8:00 a.m. – 5:00 p.m., closed holidays)
General inquiries	311
Website	toronto.ca/queensway-lakeshoreconstructionprojects

Thank you for your patience. Building a great city takes time. Better infrastructure for all of us is worth the wait.